

ARSTYL® WALL PANELS STONE

Installation instructions



Architecture & Design



INSTALLATION INSTRUCTIONS

MATERIALS REQUIRED

- Sandpaper grit 150 or finer
- Brush/sponge
- Spirit level
- Ruler
- Pencil
- Nail clamps or nails; wood strip, if necessary
- Hammer
- ADEFIX® PLUS assembly adhesive
- ADEFIX® adhesive filler (ceiling/wall grouting)
- Cartridge applicator
- Circular saw with guide rail
- Protective goggles
- HDPS/PU saw
- Alignment beams
- Finish coat
- Painting tools



ADEFIX® PLUS



ADEFIX®

FITTING AND STORAGE CONDITIONS

ARSTYL® WALL PANELS STONE must be stored flat in a dry place. The recommended temperature is +15 °C to +25°C with a relative humidity of 45% to 65%. To achieve optimum results, the products should be fitted under similar moisture and temperature conditions as present after the installation (indoor environment). Fitting on a wet backing surface (fresh plaster) and in forced drying conditions (heat gun, dehumidifier, exceptionally high temperature) are to be ruled out.

Check panels and substrates for suitability. The following backing surfaces are suitable: indoor plastered or papered surfaces, coated plaster. Surfaces must be clean, dry, free from dust, degreased and flat; rough down if necessary. If the product is to be applied to particular backing surfaces, please consult our technical department.

Where ARSTYL® WALL PANELS STONE are being used on uninsulated outside walls, the dew point may shift, and an expert moisture protection assessment may be necessary.

FINISH COATING

The factory-primed ARSTYL® WALL PANELS STONE must be coated with a finishing paint. The finish coating can in most cases be applied to the panels before assembly. An undercoat is recommended. Suitable top coats include water-based emulsion paints, acrylic or PU-based emulsion paints. It is always recommended to perform a test coat. Follow the paint manufacturer's instructions.

VARIED INSTALLATION USING 2-PANEL SYSTEM

ARSTYL® WALL PANELS STONE allow varied wall installation options. The box contains 2 different panel variants – A and B. Both variants are identified accordingly on the back. We recommend that they are used alternately.

PANEL A



PANEL B

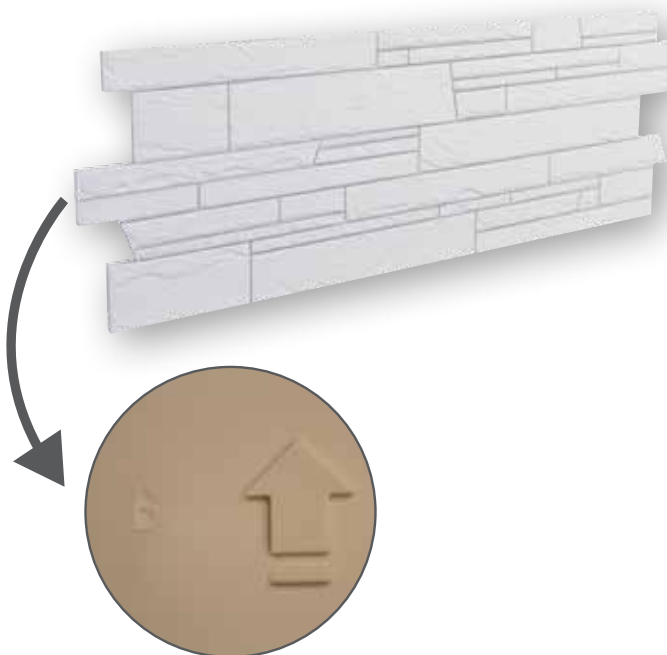

The panels should be mounted in a staggered pattern, and various rows can also be rotated 180 degrees. Make sure at the beginning of each row that the vertical joints are not directly above each other. Within a given row, the panels must face in the same direction because of their toothed edges.

Example:

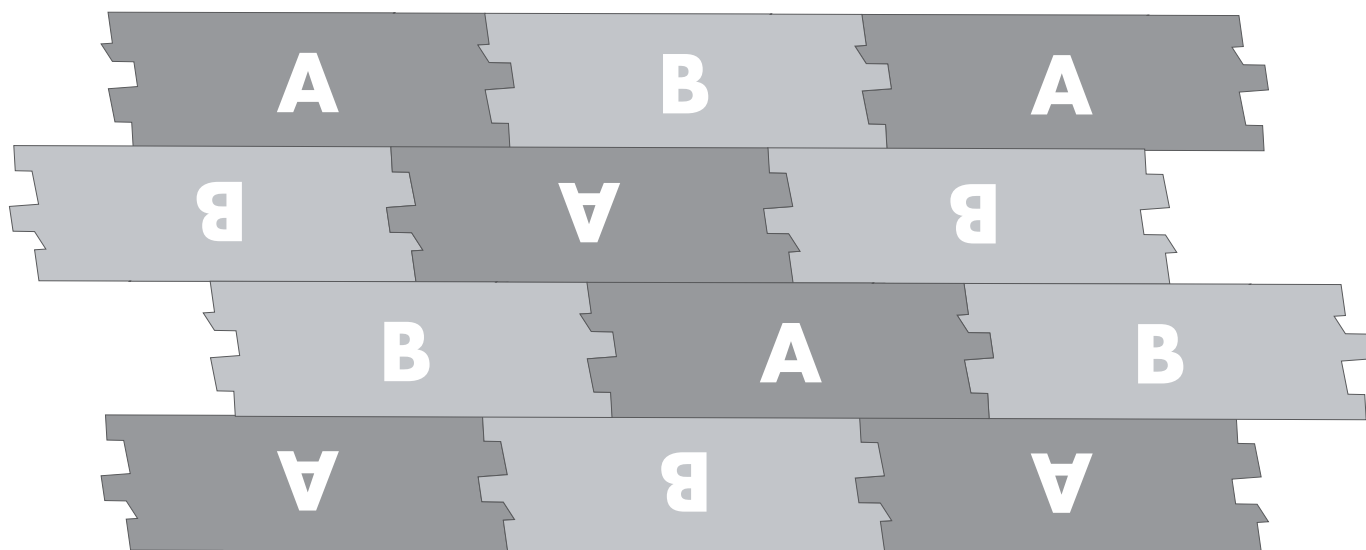

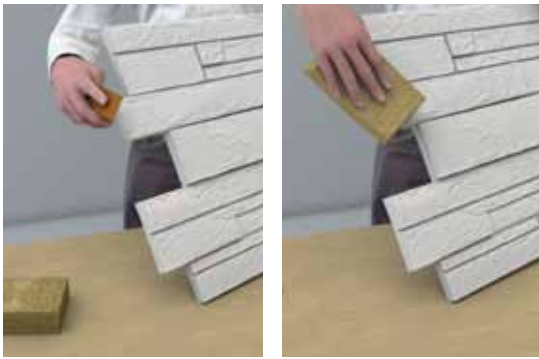

PREPARATION

Prepare the panels, lightly sand edges if necessary with sandpaper grit 150 or finer (breaks). Wipe edges and panel surface with a damp sponge and dry.

Apply the top coat of paint if appropriate. Please follow the tip on page 2.



INSTALLATION

Measure the wall and establish the position of the panels. Set out the lower laying line using a spirit level.

TIP:

We recommend starting the installation in the middle of the wall, so that the panels can later be trimmed to fit where the walls and ceiling meet.



On the lower laying line, use nails and wooden battens if necessary or nail clamps.



Clamp the adhesive cartridge, cut cartridge nozzle (diameter 5-8 mm).



Apply a continuous line (bead) of ADEFIX® PLUS mounting adhesive to the rear mounting surfaces.



Position the panels and embed them in the adhesive bed.



Butt-join the panels, making sure that the toothed edges meet with no gaps (you may need a hammer and wooden batten).

NOTE:

Butt joint areas must be not glued or grouted. It should be noted that the connection point remains slightly visible after completion. This is not a reason for complaint.



Measure the size of the panels to be trimmed in the wall and ceiling connection area and transfer to the back of the panels.



Cut the panels to fit (Hand saw with set beam or circular saw with rail).



Professionally grout the ceiling and wall connection area with ADEFIX[®] adhesive filler.

NOTE:

The back of the wall panels is uneven and has cavities. If a panel is mounted such that a cut-side remains visible, it can be smoothly filled with ADEFIX[®] PLUS and ADEFIX[®]. In this case, make sure that the upper surface levelling coat is made only with ADEFIX[®].



If final painting has not been undertaken before assembly, apply the final coat of paint to the panels after drying of the adhesive (approx. 4 hours).



SUPPLEMENTARY INFORMATION

- Holes and cut outs can be made with standard hole saws, angular cut outs with a jig saw.
- You can mitre the panels using a hand-held circular saw with a guide bar.



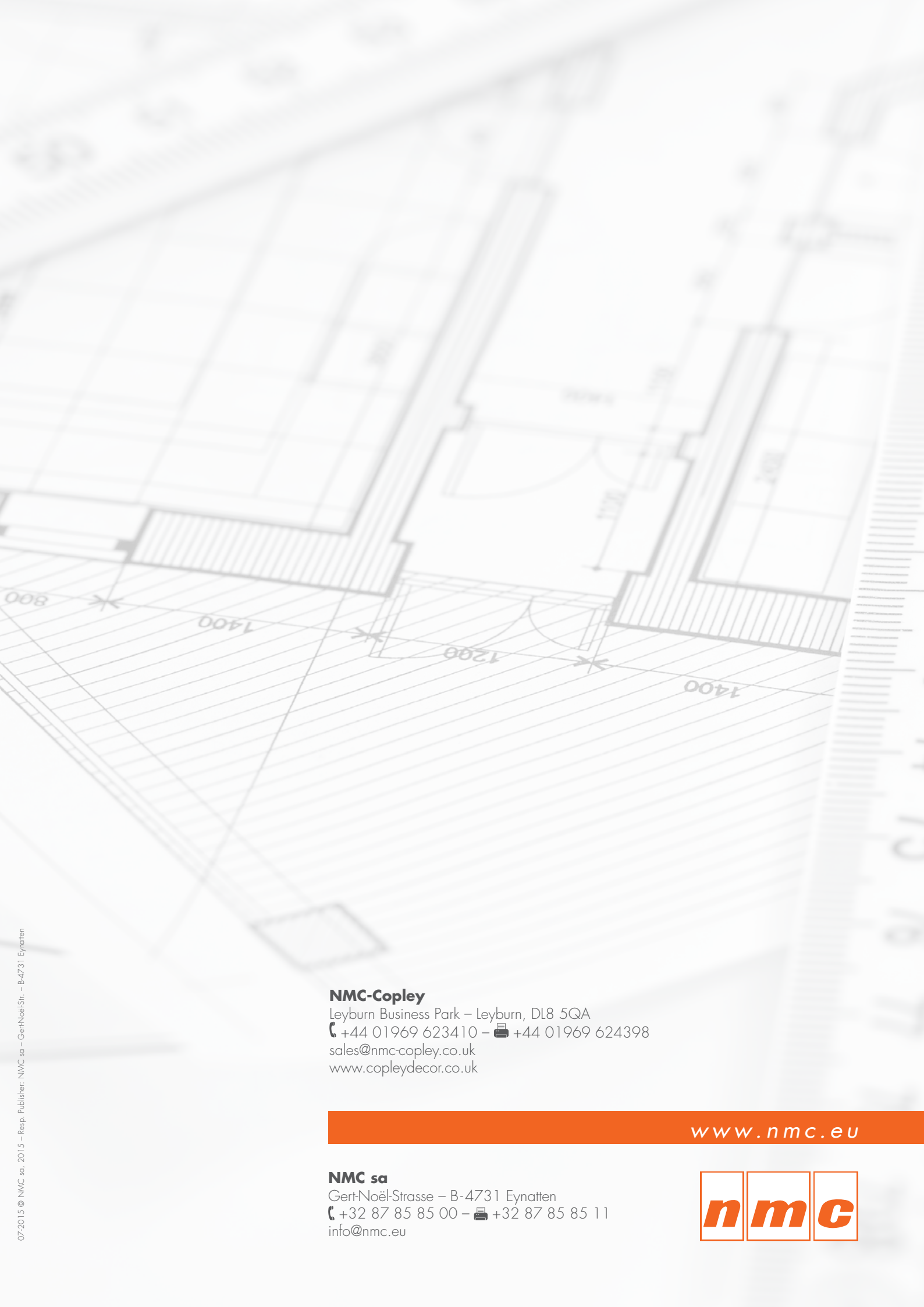

NMC-Copley

Leyburn Business Park – Leyburn, DL8 5QA

☎ +44 01969 623410 – 📠 +44 01969 624398

sales@nmc-copley.co.uk

www.copleydecor.co.uk

www.nmc.eu

NMC sa

Gert-Noël-Strasse – B-4731 Eynatten

☎ +32 87 85 85 00 – 📠 +32 87 85 85 11

info@nmc.eu

